

Hydromassage pumps

Wiper 3

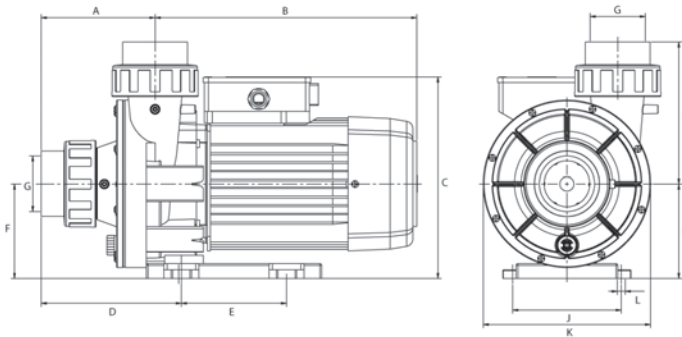
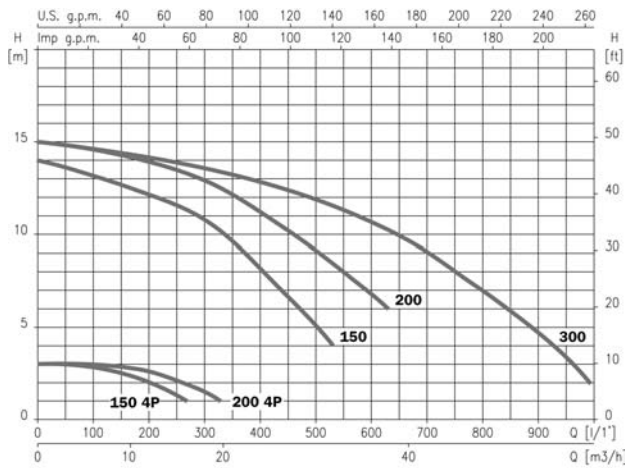

	A	B	C	D	E	F	G	H	I	J	K	L	M	Kg
Wiper3 150M	130	298.7	230	160	120	108	63	162	108	124	191	9	29	14.3
Wiper3 150M	130	298.7	230	160	120	108	63	162	108	124	191	9	29	17
Wiper3 200M	130	298.7	230	160	120	108	63	162	108	124	191	9	29	17
Wiper3 300M	130	298.7	230	160	120	108	63	162	108	124	191	9	29	18.8

230 V 50 hz	230/400 V 50 hz	A	P1 (kW)		kW	HP	µF	l/1'											
			1~ 230 V	3~ 230 V 400 V				1~	3~	m³/h	50	100	200	300	400	500	600	900	
				230 V															400 V
Wiper3 150M	2P	Wiper3 150	6.4	5	2.9	1.4	1.2	1.1	1.5	25	13.3	13	12.1	10.8	8.2	5			
	4P		1.4	-	-	0.35	-	0.18	0.25	16	3	2.8	2						
Wiper3 200M	2P	Wiper3 200	8.8	6.6	3.8	2	1.8	1.5	2	40	14.8	14.5	13.9	12.9	11.1	9.1	6.8		
	4P		1.7	-	-	0.4	-	0.18	0.25	16	3	2.8	2.6	1.5					
Wiper3 300M	Wiper3 300		11	7.1	4.1	2.5	2.4	2	3	60	14.8	14.5	14.1	13.5	12.8	11.9	10.7	4.7	

Applications

For use with domestic and commercial spa's.

Materials

Pump Body

Glass loaded polypropylene

Impeller

Glass loaded noryl.

Shaft

Stainless steel AISI 420.

Mechanical Seal

Graphite and alumine.

Motor

Insulation resistance 3750 V.

Class F Insulation.

Protection IP 55.

Continuous operation.

Built-in thermal protection.

Equipment

Complete with suction and discharge connections metric or imperial.

See our whirlpool accessories catalogue for full details